

ISS	REVISED BY:	REVISION DATE	ECD #

NOTES:

MATERIAL: BAR; STEEL, PER ASTM A615, 75 KSI YIELD

DIMENSIONS: INCHES

MECHANICAL RATING:

ULTIMATE TENSILE STRENGTH - 44 KIPS

WILLIAMS FORM PART NUMBER: R61-06

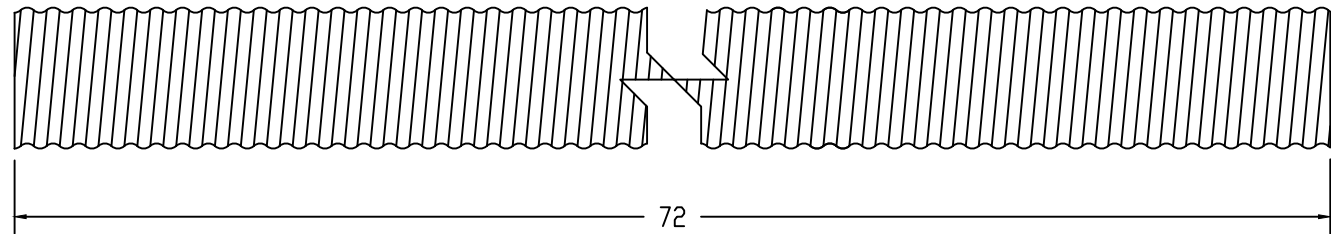
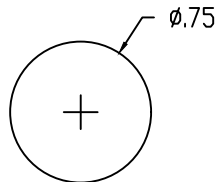

CATALOG NUMBER:			21120
SHEET NAME:		Sheet1	1 OF 1
DRAWING DESCRIPTION:			CTB-6 CONTINUOUS THREAD BAR ø3/4" X 72"
DRAWN BY:	DH	DATE:	06/28/21
APPRVD:		DR	



WWW.MACLEANPOWER.COM

This drawing contains confidential information that is the property of MacLean Power, L.L.C. ("MacLean"). Use of MacLean's confidential information without MacLean's express written consent is strictly prohibited and may expose you to legal liability. If you believe that you received this material in error, please destroy it or return it to MacLean Power, L.L.C., Kingsley Park Five, 481 Munn Rd. Suite 300, Fort Mill, SC 29715, USA.